



**EM PRODUCTS™**

PHILLIPS & TEMRO INDUSTRIES

# Spark Arrestor Silencers

## Model SSU Series

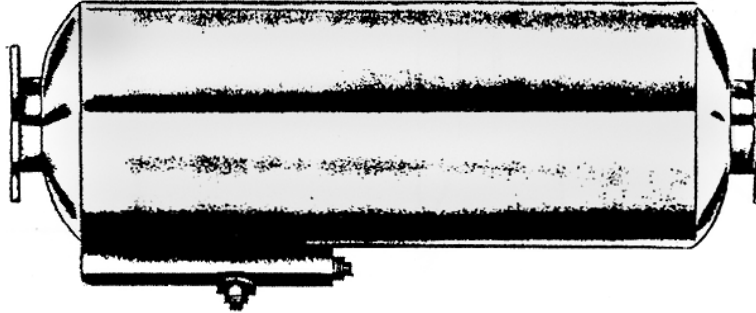

### Standard Silencer Application

- Exhaust spark arrestor
- Designed for use on internal combustion engines
- Effective in residential areas where reduction of incandescent carbon to atmosphere is desirable

### Standard Construction Features

- Easy access cleanouts
- Reactive type silencer
- Can be mounted vertically or horizontally
- High temperature (1200° F.) satin black finish

### Optional Construction Features and Accessories

- Complete line of accessories
- Larger sizes available upon request

Side inlet/end outlet connection style available on Model SRU and Model SSU. Please consult factory for additional information.

REV. 01/99  
99EC-4000



# Spark Arrestors—“SSU” Series

## Industrial Grade

### End Inlet / End Outlet

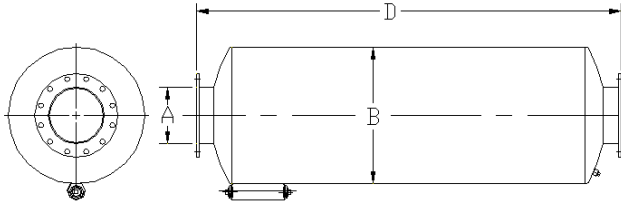

Part Number	A	B	D	Wt
SSUE-15-981046	1.5	8	20	18
SSUE-02981047	2	8	21	20
SSUE-25-981048	2.5	10	22	27
SSUE-03-981049	3	12	26	37
SSUE-35-981050	3.5	14	30	60
SSUE-04-980338	4	14	32	82
SSUE-05-980218	5	14	42	102
SSUE-06-980340	6	18	49	162
SSUE-08-980341	8	22	50	245
SSUE-10-980342	10	26	63	330
SSUE-12-980343	12	30	76	555
SSUE-14-980344	14	36	78	825
SSUE-16-980345	16	42	81	860
SSUE-18-980346	18	48	100	1390
SSUE-20-980347	20	48	118	1540
SSUE-22-980348	22	54	120	1900
SSUE-24-980349	24	60	132	2270

### Side Inlet / End Outlet

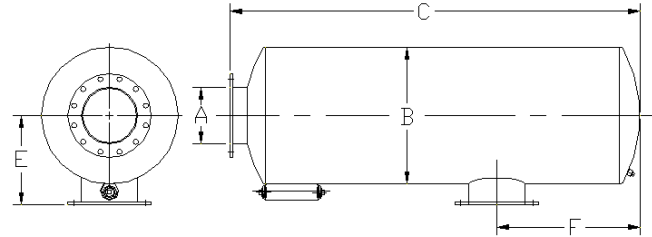

Part Number	A	B	C	E	F	WT
SSUS-25-981407	2.5	Not Available				
SSUS-03-981408	3					
SSUS-35-981409	3.5					
SSUS-04-941189	4					
SSUS-05-981190	5	14	39.75	11	7.00	102
SSUS-06-981191	6	18	45.50	13	8.25	162
SSUS-08-981192	8	22	46.50	17	9.75	245
SSUS-10-981193	10	26	59.50	19	11.50	330
SSUS-12-981194	12	30	73.00	20	13.25	555
SSUS-14-981195	14	36	75.50	24	15.00	825
SSUS-16-981196	16	42	79.00	27	16.50	860
SSUS-18-981197	18	48	97.00	33	19.00	1390
SSUS-20-981198	20	48	115.00	33	20.00	1540
SSUS-22-981199	22	54	116.50	36	22.00	1900
SSUS-24-981200	24	60	129.50	39	23.50	2270

Note: 3 1/2 inch and smaller standard with male NPT connections; 4 inch and larger standard with 150 # ANSI drilled plate flange connections. Dimensions in inches, weights in pounds. Dimensions and weights are nominal and may vary slightly with production models

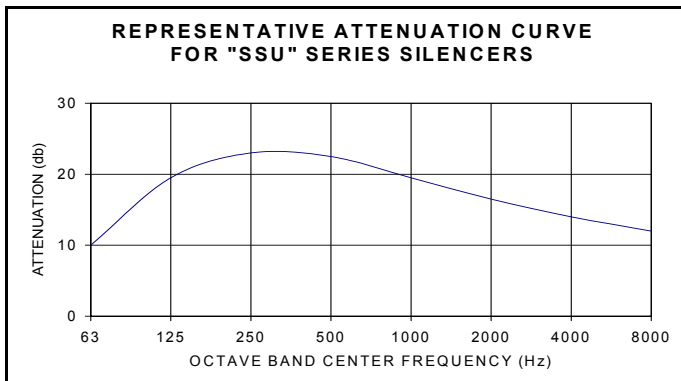

- Typical Reduction = 12 – 18 dBA
- Carbon Steel Construction
- Stainless Steel Construction Available
- Contact Factory for Custom Fit Applications

3200-012