

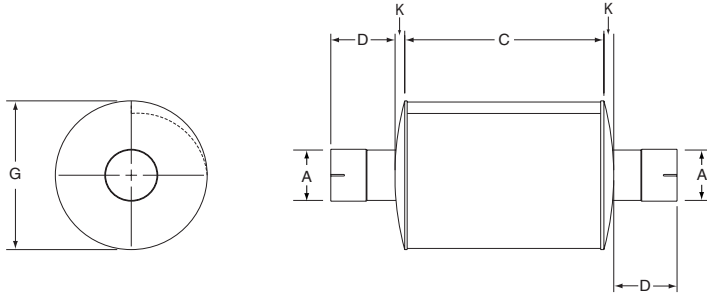

TS Residential Grade - SV Model

Typical Insertion Loss 22-28 dbA*



Features

- Compact Spiral Chamber Design
- Premium Silencing
- Low Back Pressure
- Low Weight
- Aluminized Steel Construction
Maximum Temp: 1200 °F (650 °C)
- Standard High-Temperature Finish
- All MIG Welded Construction
- Steel Wool and Mesh Liner
- Slip-fit Connections Standard

Options

- Factory Customization Available
- 316L Stainless Steel Construction
- Reverse Flow
- Inlet/Outlet Configurations
- 125/150# A.N.S.I. Flange Connections
- Male/Female N.P.T. Connections
- Exterior Finishes
- Complete line of Accessories and Mounting Brackets

*Actual insertion loss value may vary by application.
All measurements in inches unless otherwise noted.

COWL Model No.	COWL Part No.	Inlet A dia. (I.D.)	C	D	G	K	Approximate Weight
TS20SV	TS20SV000	2.00	9.24	3.25	11.81	0.75	32 lbs
TS25SV	TS25SV000	2.50	11.49	3.25	11.81	0.75	39 lbs
TS30SV	TS30SV000	3.00	15.49	5.25	11.81	0.75	47 lbs
TS35SV	TS35SV000	3.50	16.50	5.00	16.06	1.00	70 lbs
TS40SV	TS40SV000	4.00	22.49	5.00	16.06	1.00	90 lbs
TS45SV	TS45SV000	4.50	22.49	5.00	16.06	1.00	90 lbs
TS50SV-7	TS50SV-7000	5.00	15.35	4.55	22.00	1.45	103 lbs
TS50SV-8	TS50SV-8000	5.00	24.27	4.55	22.00	1.45	150 lbs
TS60SV	TS60SV000	6.00	24.27	4.55	22.00	1.45	155 lbs
TS80SV-10	TS80SV-10000	8.00	30.08	6.25	28.00	1.75	230 lbs
TS80SV-12	TS80SV-12000	8.00	36.08	5.75	33.00	2.25	330 lbs

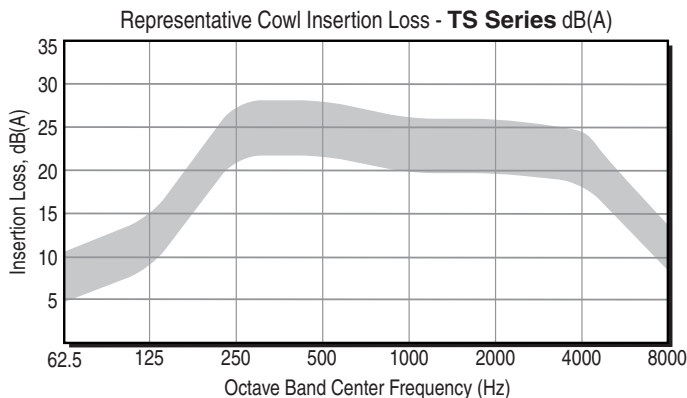

Engine Exhaust Silencer & Accessories

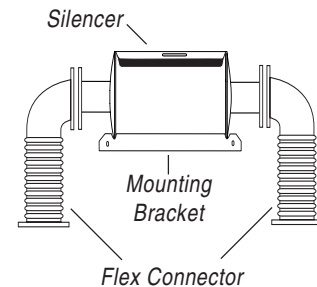

Not pictured: Insulation Blanket

TS-SV



TS Residential Grade - SV Model

Typical Insertion Loss 22-28 dbA*

Metric Units

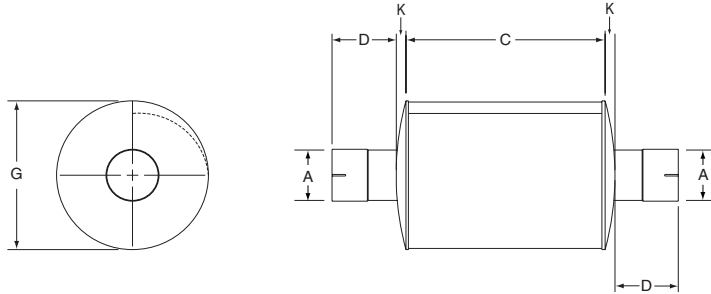

Features

- Compact Spiral Chamber Design
- Premium Silencing
- Low Back Pressure
- Low Weight
- Aluminized Steel Construction
Maximum Temp: 1200 °F (650 °C)
- Standard High-Temperature Finish
- All MIG Welded Construction
- Steel Wool and Mesh Liner
- Slip-fit Connections Standard

Options

- Factory Customization Available
- 316L Stainless Steel Construction
- Reverse Flow
- Inlet/Outlet Configurations
- 125/150# A.N.S.I. Flange Connections
- Male/Female N.P.T. Connections
- Exterior Finishes
- Complete line of Accessories and Mounting Brackets

*Actual insertion loss value may vary by application.

All measurements in millimeters unless otherwise noted.

COWL Model No.	COWL Part No.	Inlet A dia. (I.D.)	C	D	G	K	Approximate Weight
TS20SV	TS20SV000	51	235	83	300	19	15 kg
TS25SV	TS25SV000	64	292	83	300	19	18 kg
TS30SV	TS30SV000	76	393	133	300	19	22 kg
TS35SV	TS35SV000	89	419	127	408	25	32 kg
TS40SV	TS40SV000	102	571	127	408	25	41 kg
TS45SV	TS45SV000	114	571	127	408	25	41 kg
TS50SV-7	TS50SV-7000	127	390	116	559	37	47 kg
TS50SV-8	TS50SV-8000	127	616	116	559	37	68 kg
TS60SV	TS50SV-8000	152	616	116	559	37	71 kg
TS80SV-10	TS80SV-10000	203	764	159	711	44	105 kg
TS80SV-12	TS80SV-12000	203	916	146	838	57	150 kg

Representative Cowl Insertion Loss - TS Series dB(A)

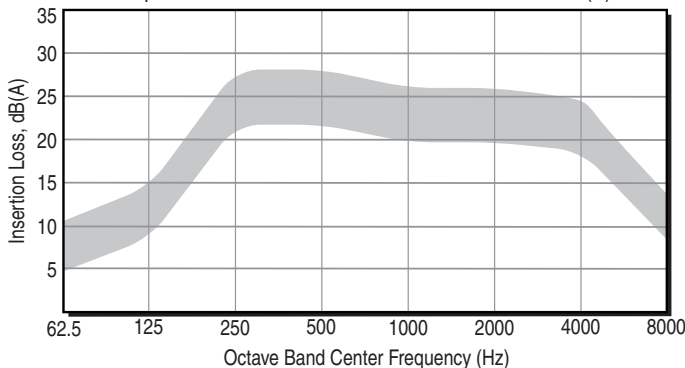

Engine Exhaust Silencer & Accessories

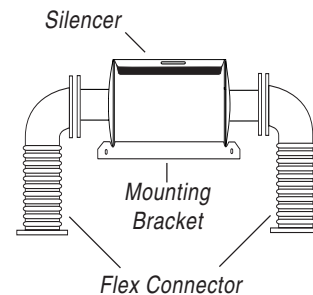

Not pictured: Insulation Blanket